

1 **MAGNA1 25-100**

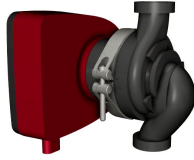

MAGNA1 -

MAGNA1

MAGNA1

EuP.

: -10 .. 110 °C
 : 60 °C
 : 983.2 / 3

TF : 110
 : CE,VDE,EAC,CN ROHS

EN-GJL-200
 ASTM A48-200B
 PES 30%GF

:
: 0 .. 40 °C
: 10
: G 1 1/2"
: PN10
: 180
:
-P1: 9 .. 176
: 50 Hz
: 1 x 230
: 0.09 .. 1.42 A
(IEC 34-5): X4D
(IEC 85): F
:
(EEI): 0.22
: 4.38
:
: 4.78
:
: 0.012 ³

MAGNA1 25-100 50

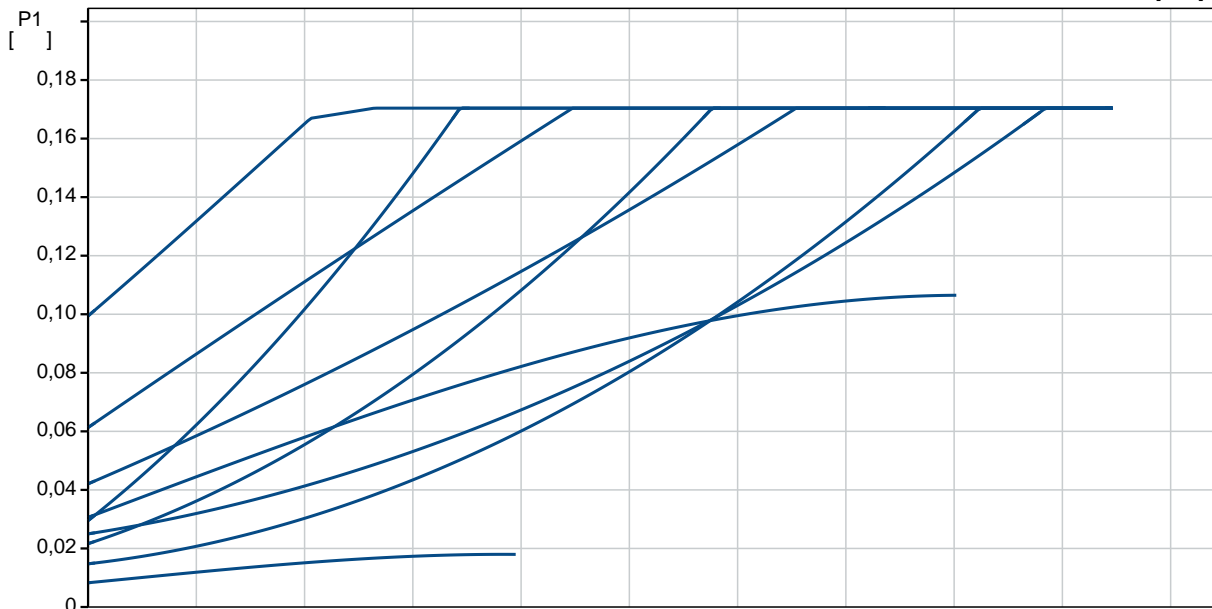
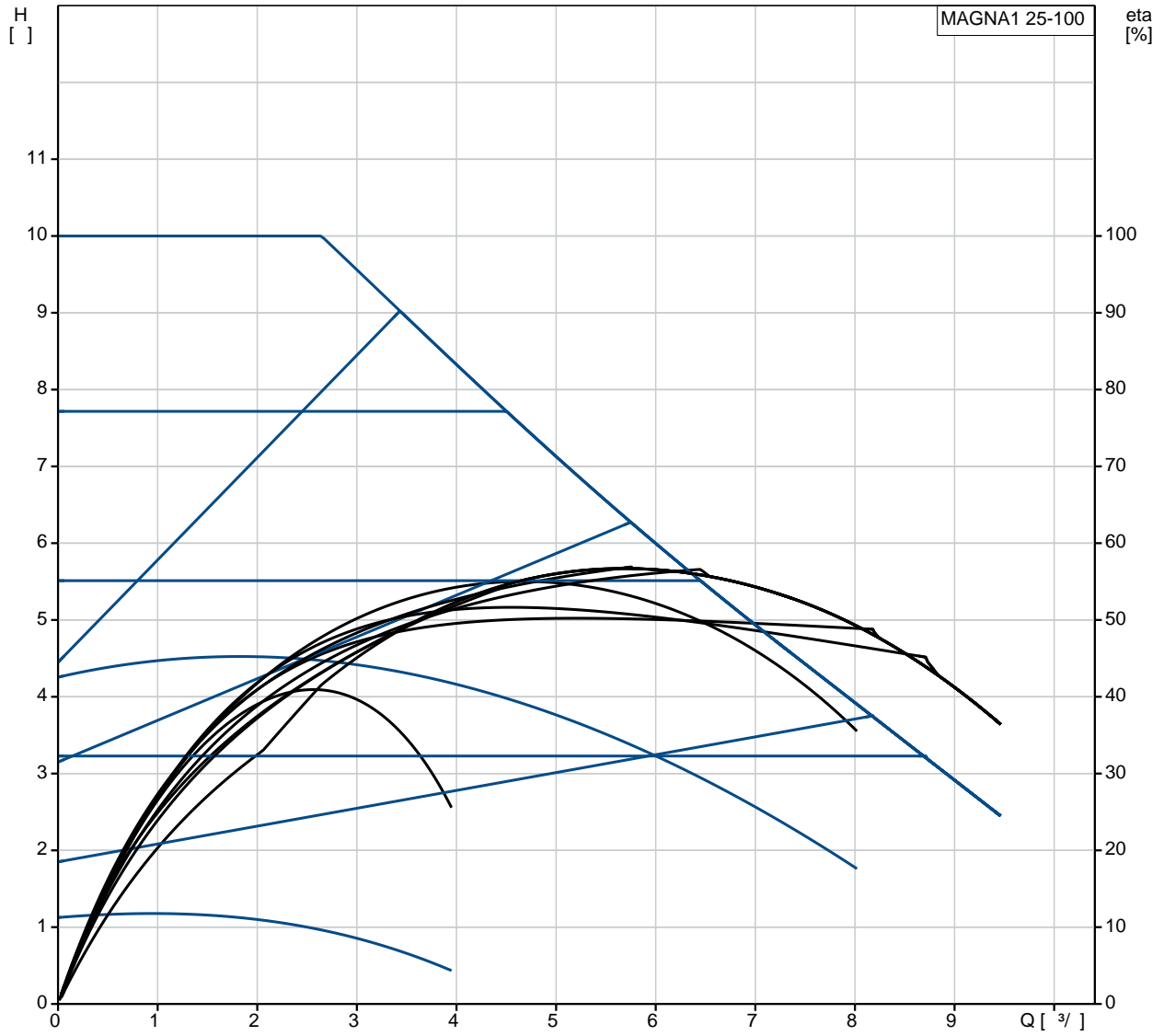

MAGNA1 25-100

EAN :

TF :

100
110
CE, VDE, EAC, CN ROHS
A

EN-GJL-200
ASTM A48-200B
PES 30%GF

0 .. 40 °C

10
G 1 1/2"
PN10
180

-10 .. 110 °C
60 °C

983.2 / ³

-P1: 9 .. 176
50 Hz
1 x 230
0.09 .. 1.42 A
(IEC 34-5): X4D
(IEC 85): F

(EEI): 0.22
4.38
4.78
0.012 ³

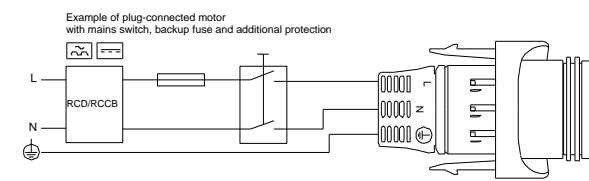
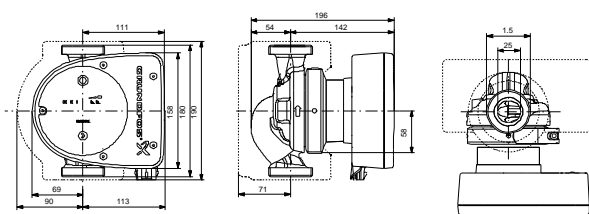
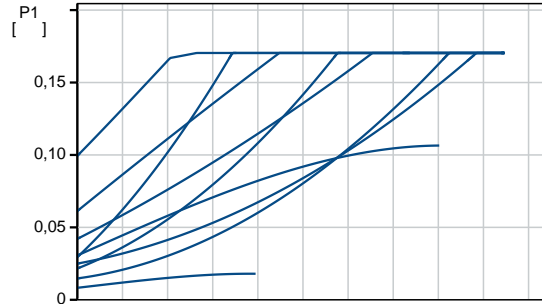
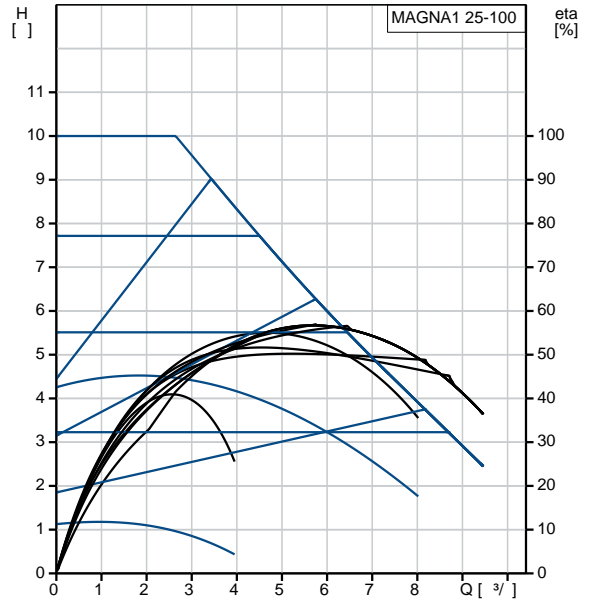

MAGNA1 25-100 50

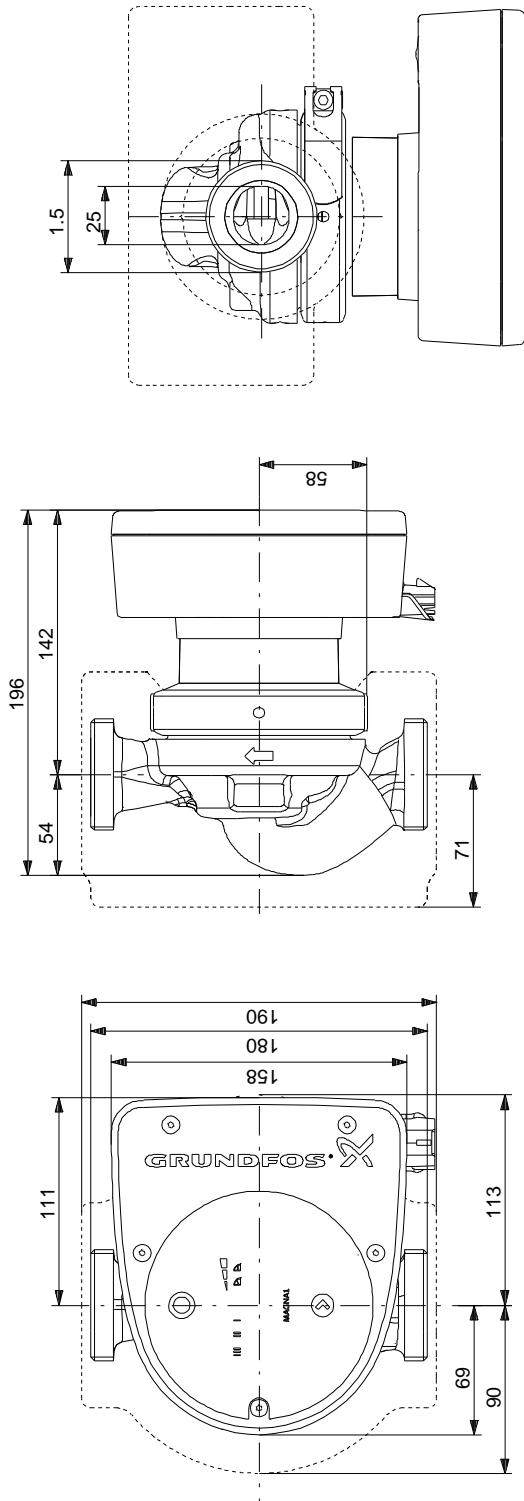

MAGNA1 25-100 50

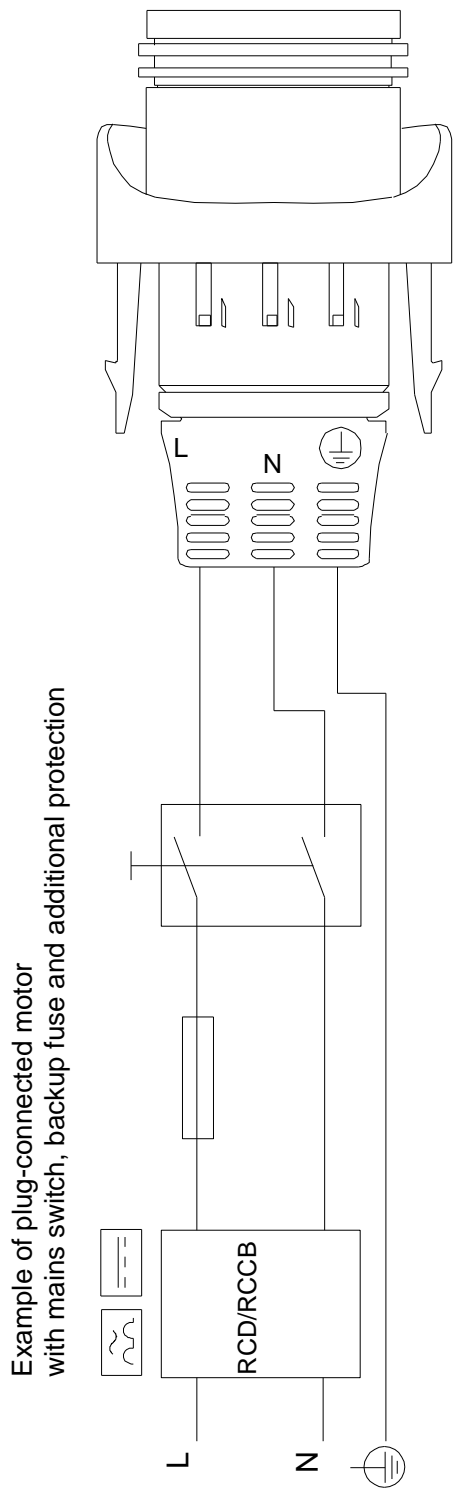

Example of plug-connected motor with mains switch, backup fuse and additional protection

! [], .