

1 **MAGNA1 32-60**

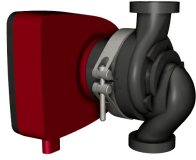

MAGNA1 -

MAGNA1

MAGNA1

EuP.

: -10 .. 110 °C
 : 60 °C
 : 983.2 / 3

TF : 110
 : CE,VDE,EAC,CN ROHS

EN-GJL-200
 ASTM A48-200B
 PES 30%GF

:
: 0 .. 40 °C
: 10
: G 2"
: PN10
: 180
:
-P1: 9 .. 111
: 50 Hz
: 1 x 230
: 0.09 .. 0.9 A
(IEC 34-5): X4D
(IEC 85): F
:
(EEI): 0.22
: 4.38
:
: 4.78
:
: 0.012 ³

MAGNA1 32-60 50

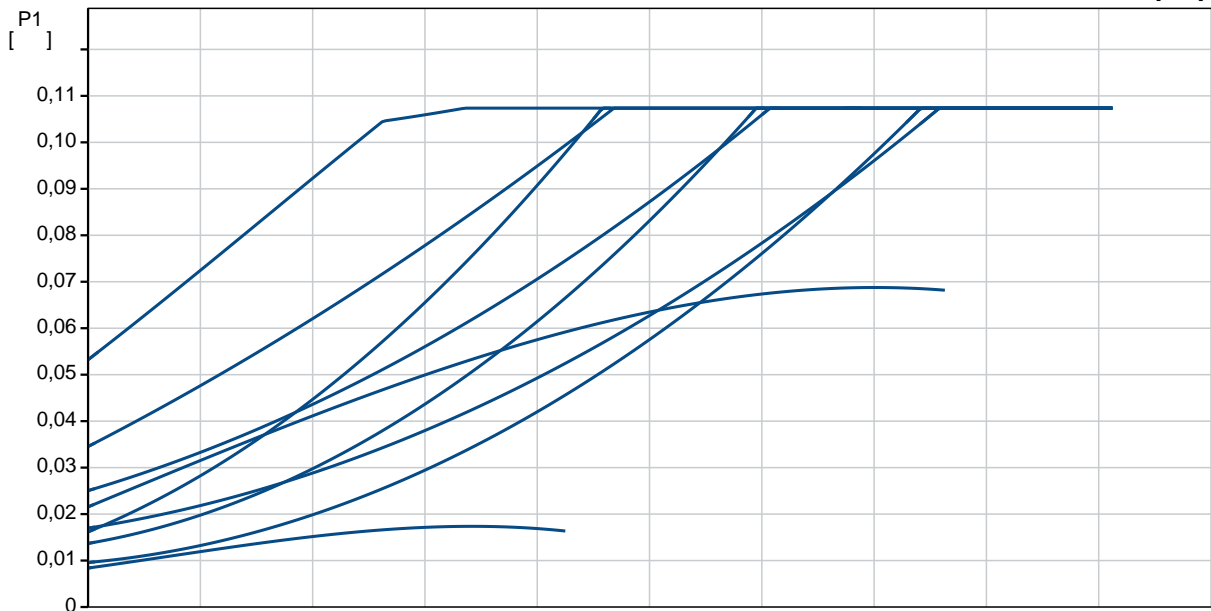
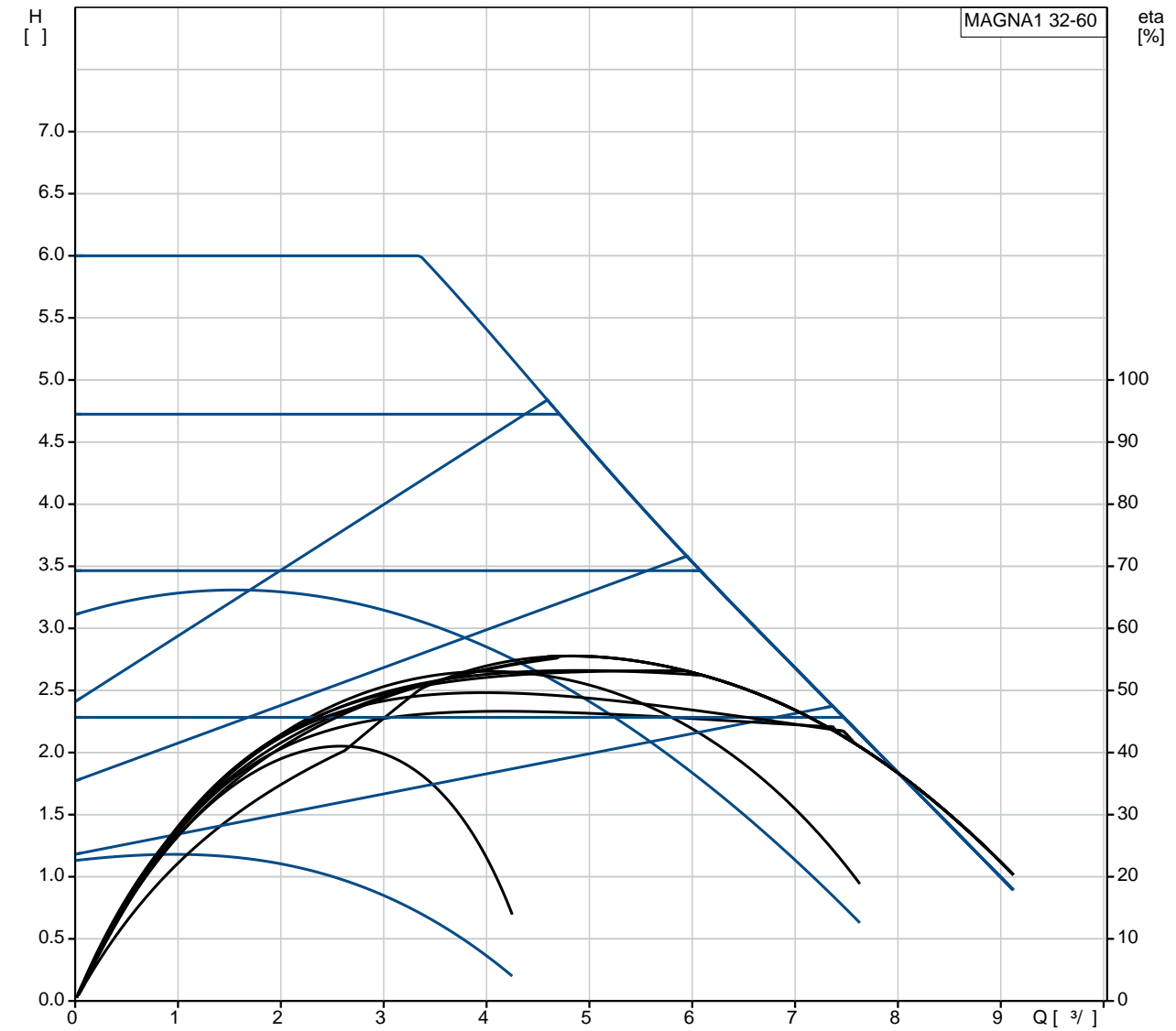

| | |
|--------------|--|
| MAGNA1 32-60 | |
| EAN | |
| TF | 60 110 CE, VDE, EAC, CN ROHS A |
| | EN-GJL-200 ASTM A48-200B PES 30%GF |
| | 0 .. 40 °C |
| | 10 G 2" PN10 180 |
| | -10 .. 110 °C 60 °C |
| | 983.2 / 3 |
| -P1: | 9 .. 111 |
| | 50 Hz |
| | 1 x 230 |
| | 0.09 .. 0.9 A |
| (IEC 34-5): | X4D |
| (IEC 85): | F |
| (EEI): | 0.22 |
| | 4.38 |
| | 4.78 |
| | 0.012 3 |

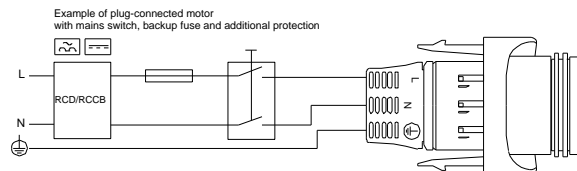
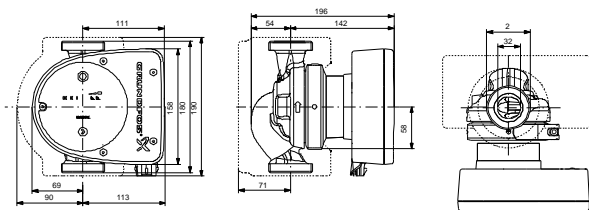
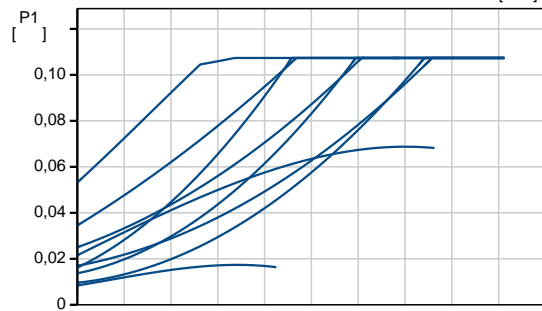
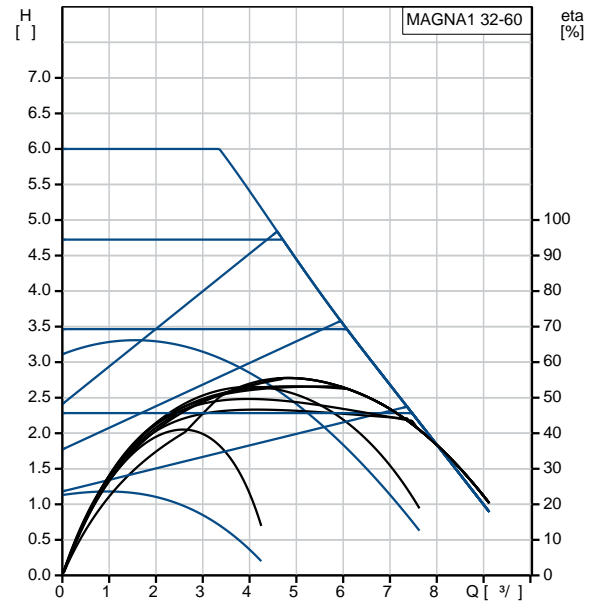

MAGNA1 32-60 50

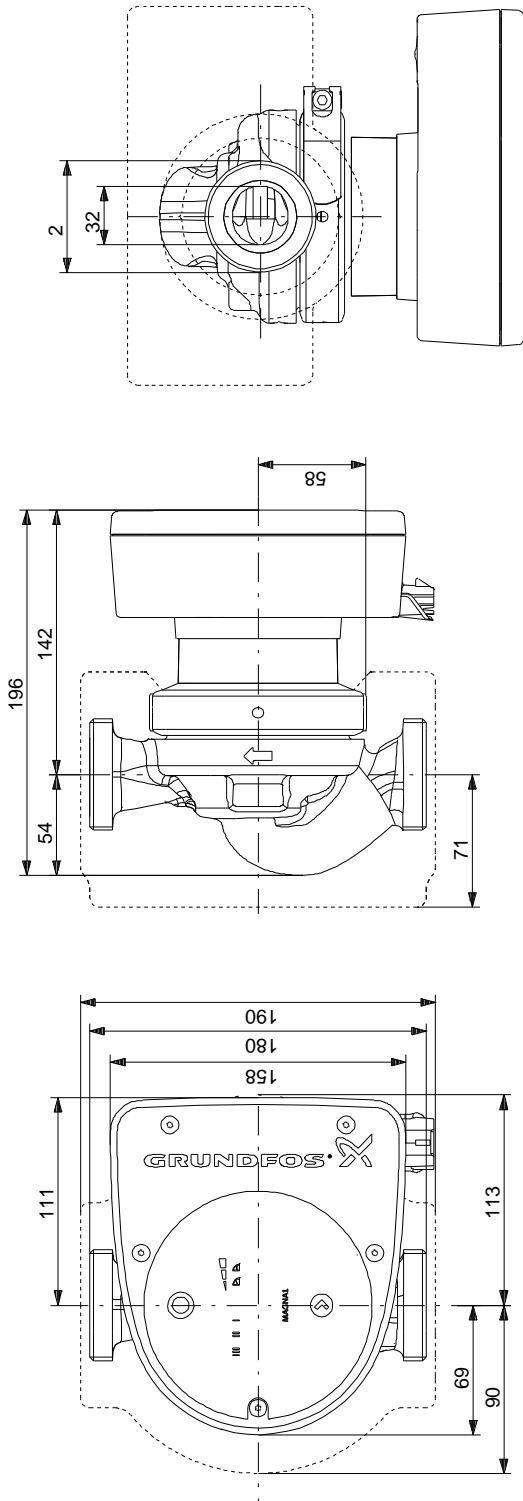

MAGNA1 32-60 50

Example of plug-connected motor
with mains switch, backup fuse and additional protection

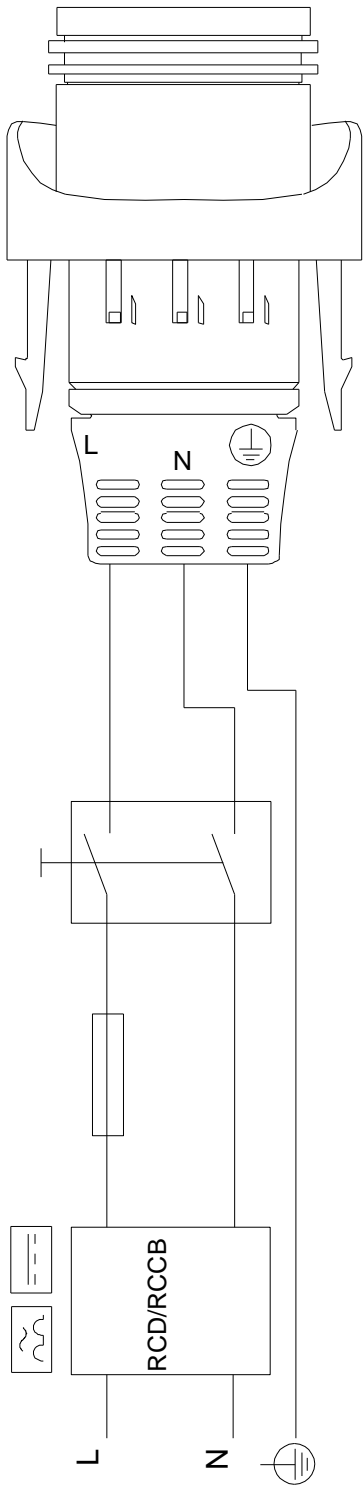

!

[],