

1 MAGNA1 65-60 F



MAGNA1 -

MAGNA1

MAGNA1

EuP.

: -10 .. 110 °C
 : 60 °C
 : 983.2 / 3

TF : 110
 : CE,VDE,EAC

EN-GJL-250
 ASTM A48-250B
 PES 30%GF

: 0 .. 40 °C

: 10
: DIN
: DN 65
: PN6/10
: 340
:
-P1: 23.15 .. 365
: 50 Hz
: 1 x 230
: 0.24 .. 1.64 A
(IEC 34-5): X4D
(IEC 85): F

:
: (EEI): 0.20
: 20.7
:
: 23
:
: 57.4 ³

MAGNA1 65-60 F 50

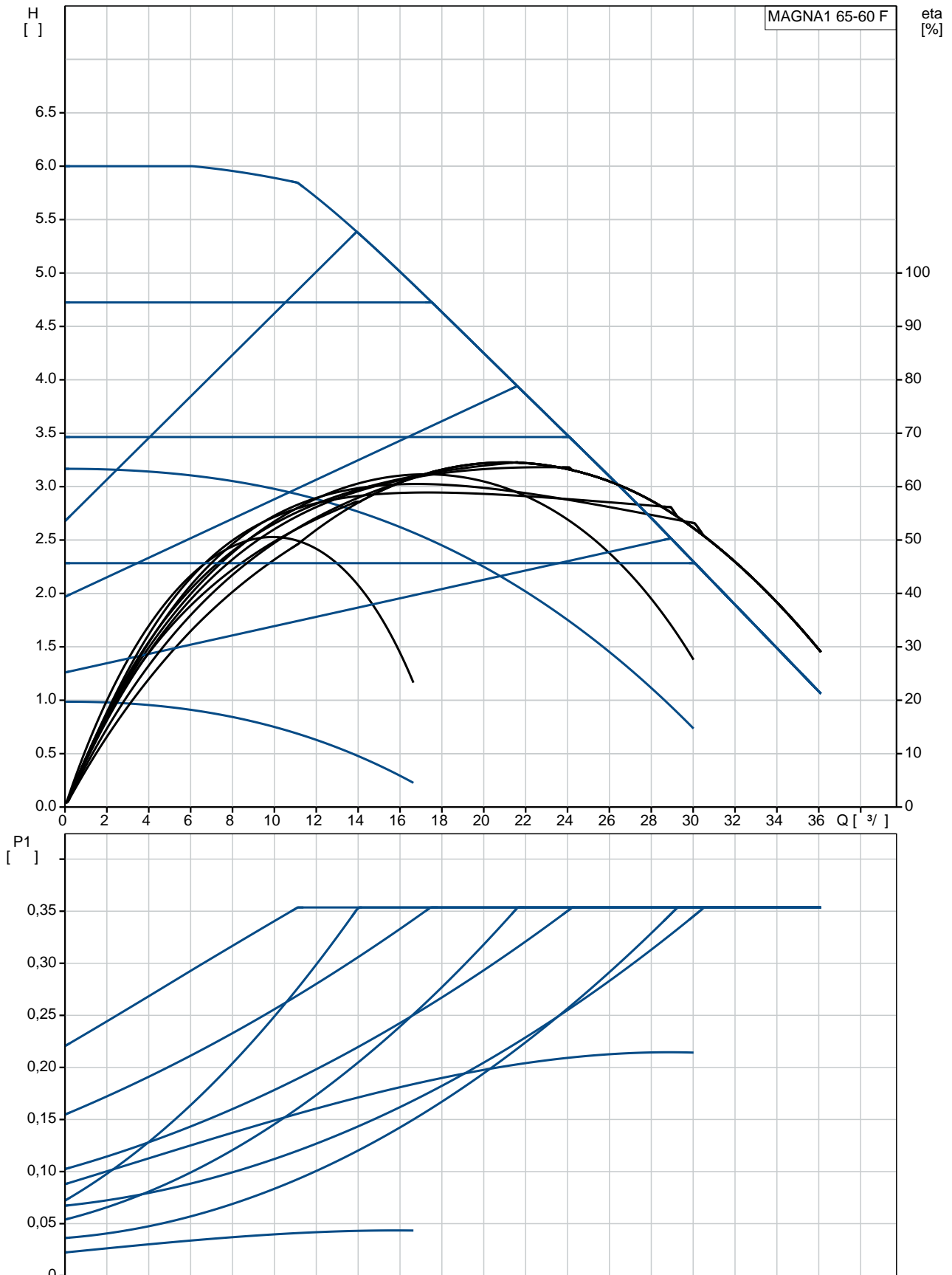

MAGNA1 65-60 F

EAN :

TF :

60
110
CE, VDE, EAC
B

EN-GJL-250
ASTM A48-250B
PES 30%GF

0 .. 40 °C

10
DIN
DN 65
PN6/10
340

-10 .. 110 °C
60 °C
983.2 / 3

-P1: 23.15 .. 365
50 Hz
1 x 230
0.24 .. 1.64 A
(IEC 34-5): X4D
(IEC 85): F

(EEI): 0.20

20.7

23

57.4 3

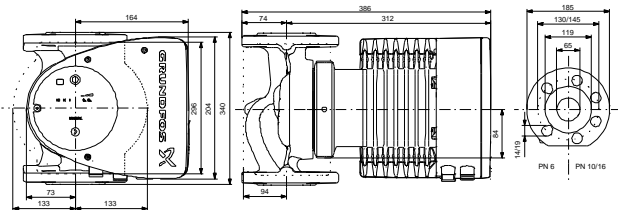
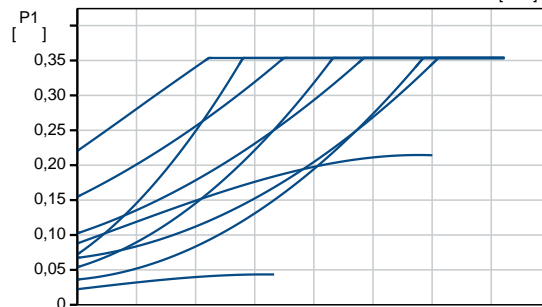
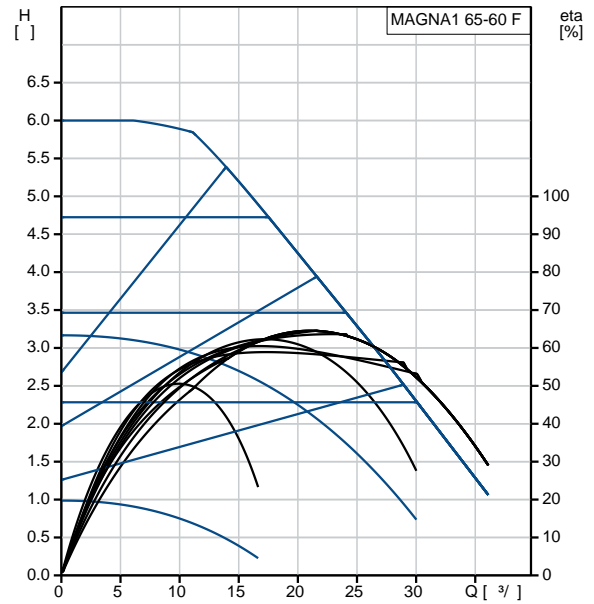

Example of mains-connected motor with mains switch, backup fuse and additional protection

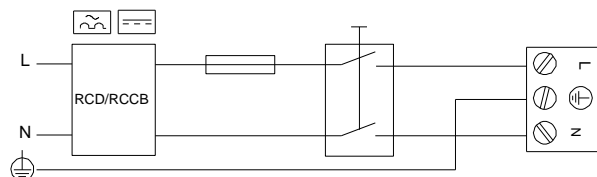

MAGNA1 65-60 F 50

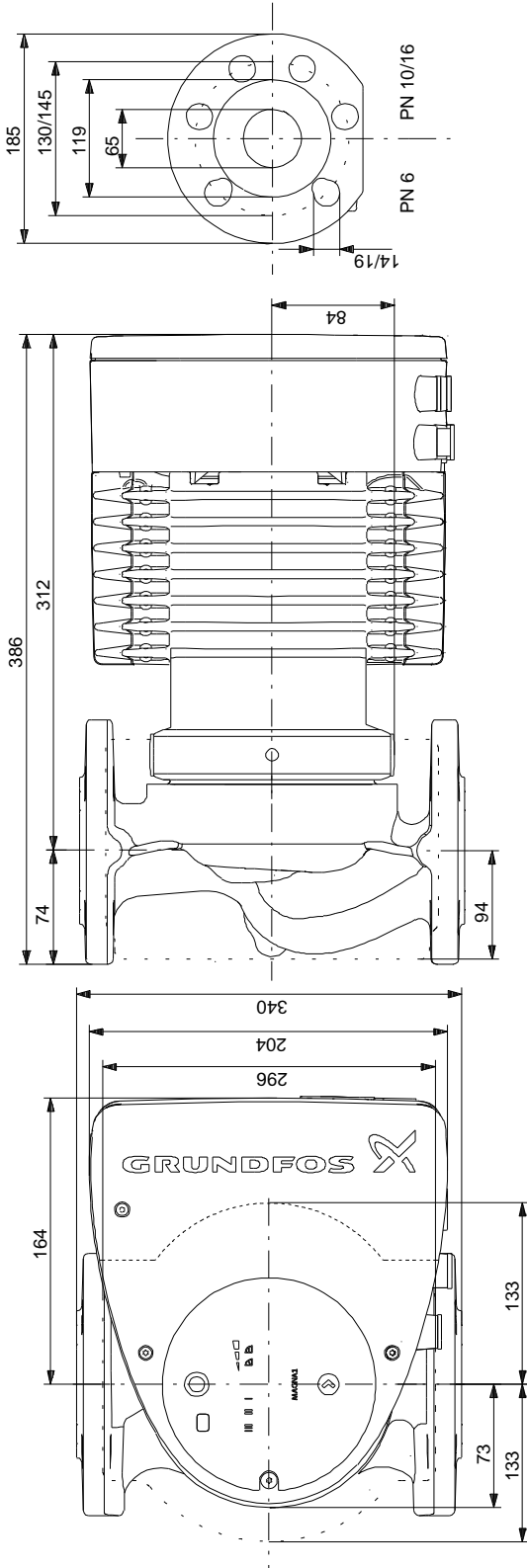

MAGNA1 65-60 F 50

Example of mains-connected motor with mains switch, backup fuse and additional protection

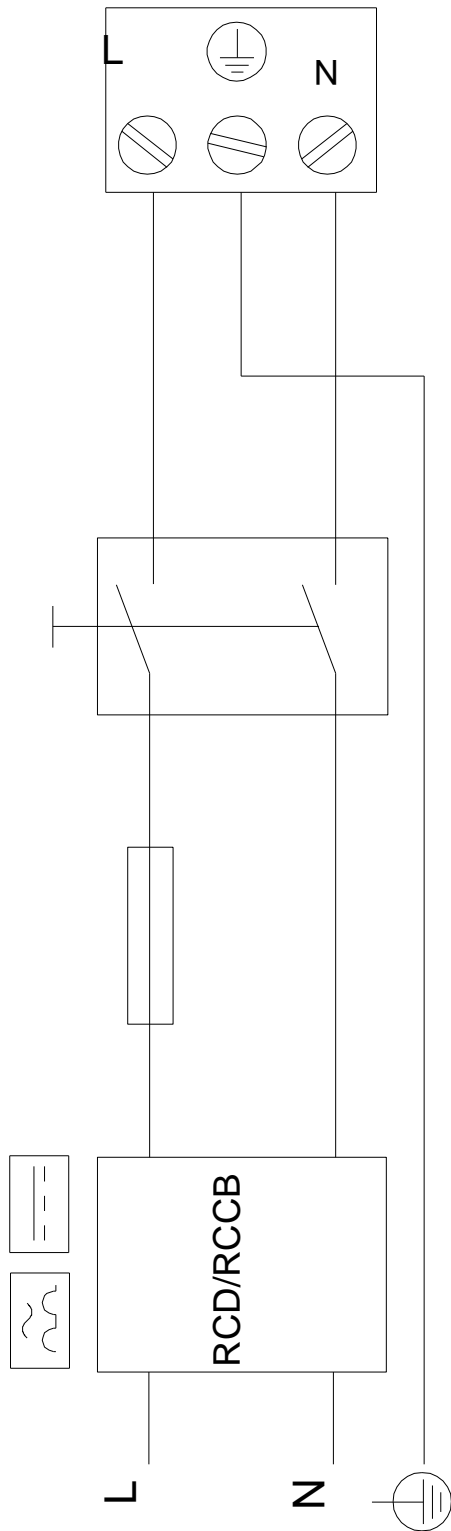

! [], .