

1 **MAGNA1 25-60**

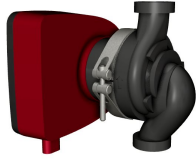

MAGNA1 -

MAGNA1

MAGNA1

EuP.

: -10 .. 110 °C  
 : 60 °C  
 : 983.2 / 3

TF : 110  
 : CE,VDE,EAC,CN ROHS

EN-GJL-200  
 ASTM A48-200B  
 PES 30%GF

:  
: 0 .. 40 °C  
: 16  
: G 1 1/2"  
: PN16  
: 180  
:  
-P1: 8 .. 87  
: 50 Hz  
: 1 x 230  
: 0.08 .. 0.7 A  
(IEC 34-5): X4D  
(IEC 85): F  
:  
(EEI): 0.21  
: 4.38  
:  
: 4.78  
:  
: 0.012 <sup>3</sup>

## MAGNA1 25-60 50

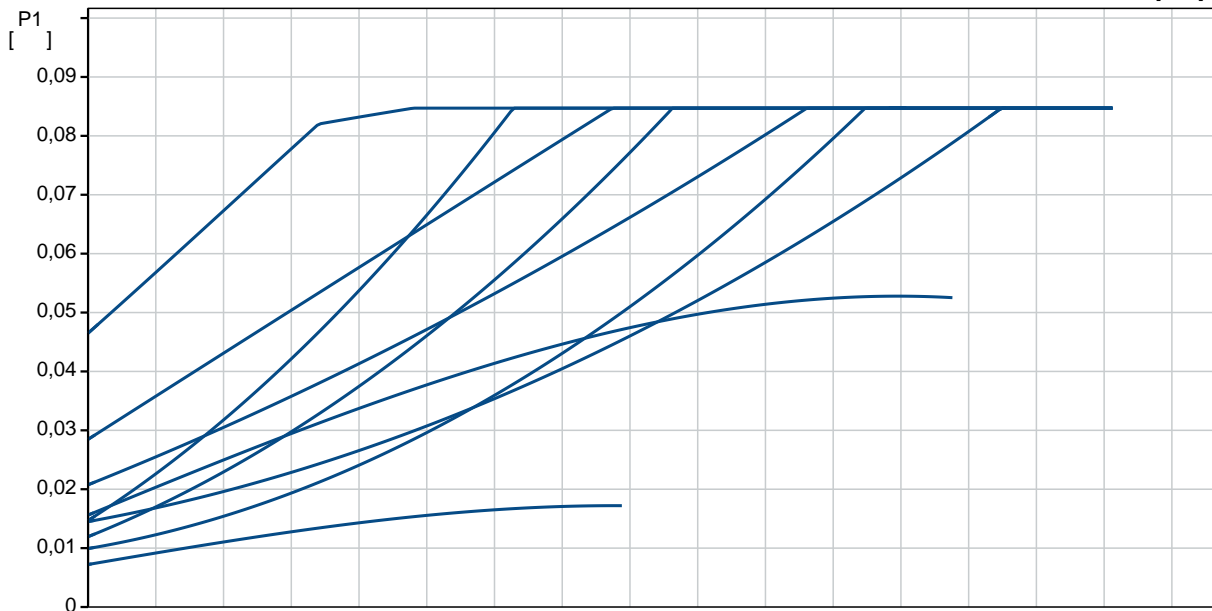
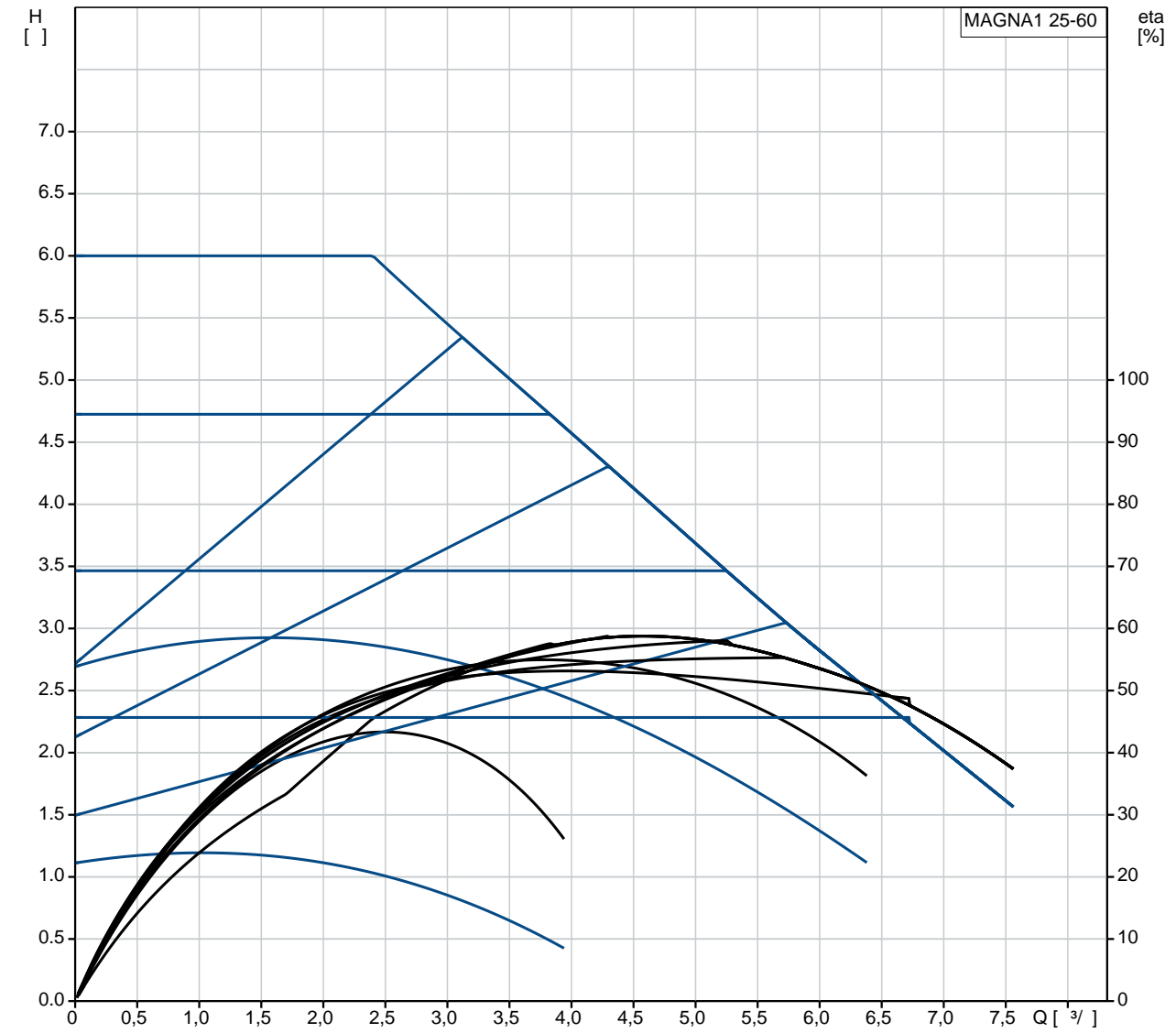

MAGNA1 25-60

EAN :

TF :

60  
110  
CE, VDE, EAC, CN ROHS  
A

EN-GJL-200  
ASTM A48-200B  
PES 30%GF

0 .. 40 °C

16  
G 1 1/2"  
PN16  
180

-10 .. 110 °C  
60 °C

983.2 / <sup>3</sup>

-P1: 8 .. 87  
50 Hz  
1 x 230  
0.08 .. 0.7 A  
(IEC 34-5): X4D  
(IEC 85): F

(EEI): 0.21  
4.38  
4.78  
0.012 <sup>3</sup>

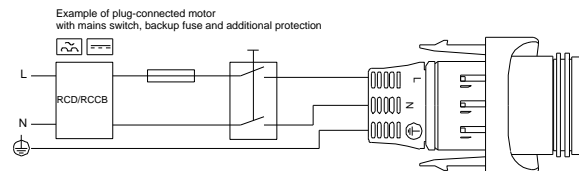
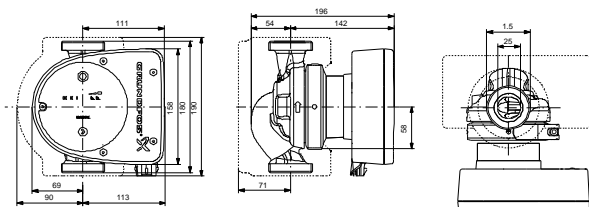
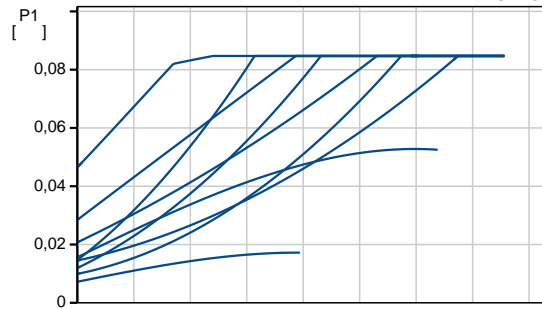
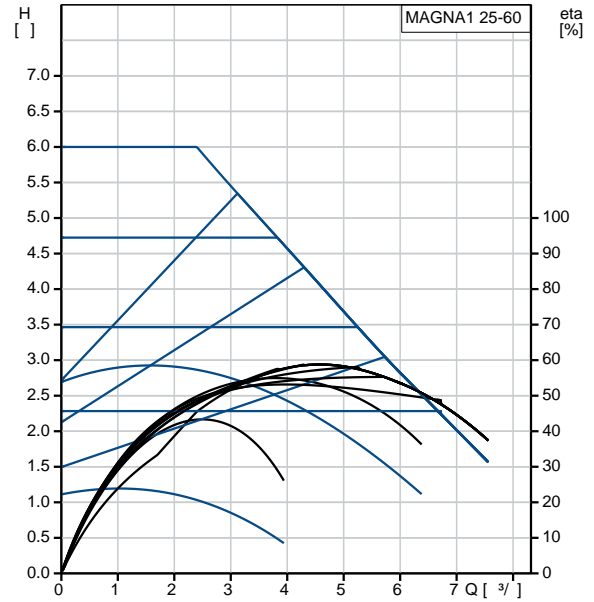

## MAGNA1 25-60 50

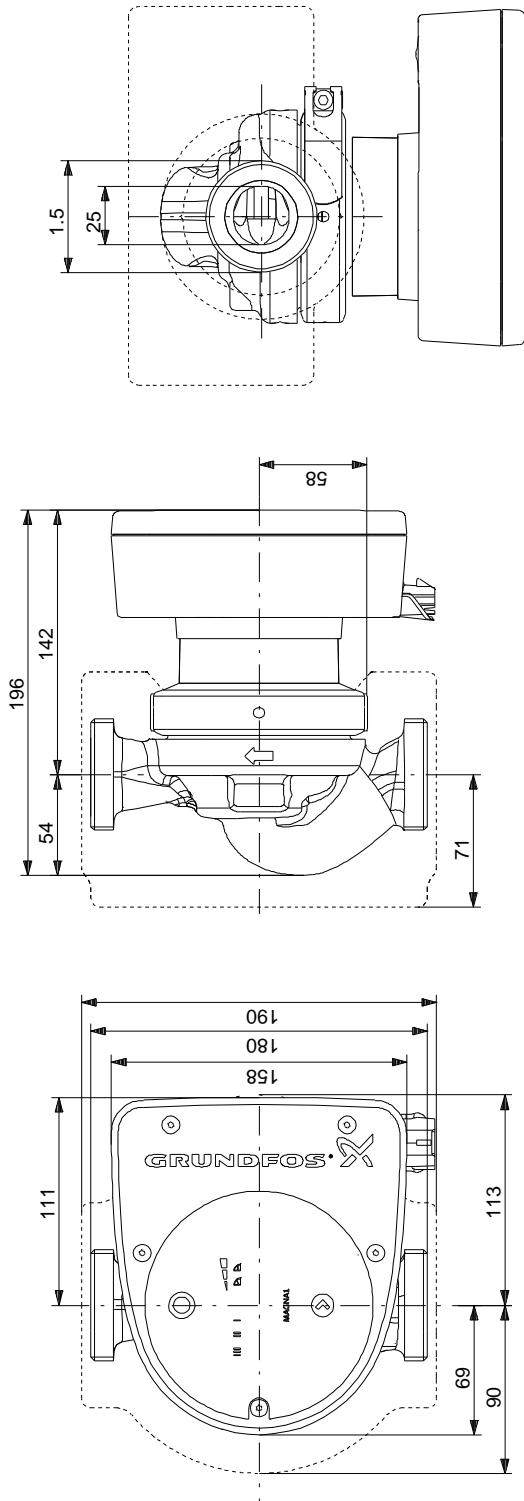

## MAGNA1 25-60 50

Example of plug-connected motor  
with mains switch, backup fuse and additional protection

